

# ASSEMBLY INSTRUCTIONS

## MODEL : X - BACK 24" BARCHAIR

### IMPORTANT NOTE :

- \* PLACE ALL WOODEN PARTS ON A CLEAN AND SMOOTH SURFACE SUCH AS A RUG OR CARPET TO AVOID THE PARTS FROM BEING SCRATCHED.
- \* BEFORE YOU BEGIN, KINDLY FOLLOW THE ASSEMBLY INSTRUCTIONS STEP BY STEP.
- \* DO NOT TIGHTEN ALL SCREWS UNTIL THE CHAIR IS FULLY SET-UP.

### HARDWARE LIST

NO	DESCRIPTION	QTY
A	JCBC BOLT (LONG)	4 PCS
B	JCBC BOLT (MEDIUM)	4 PCS
C	JCBC BOLT (SHORT)	2 PCS
D	SPRING WASHER	10 PCS
E	SPRING WASHER	10 PCS
F	WOOD SCREW	9 PCS
G	M4 ALLEN KEY	1 PC

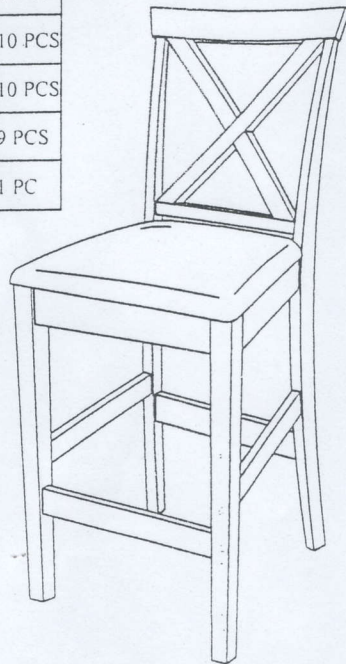

Fully Set-up

### STEP 1

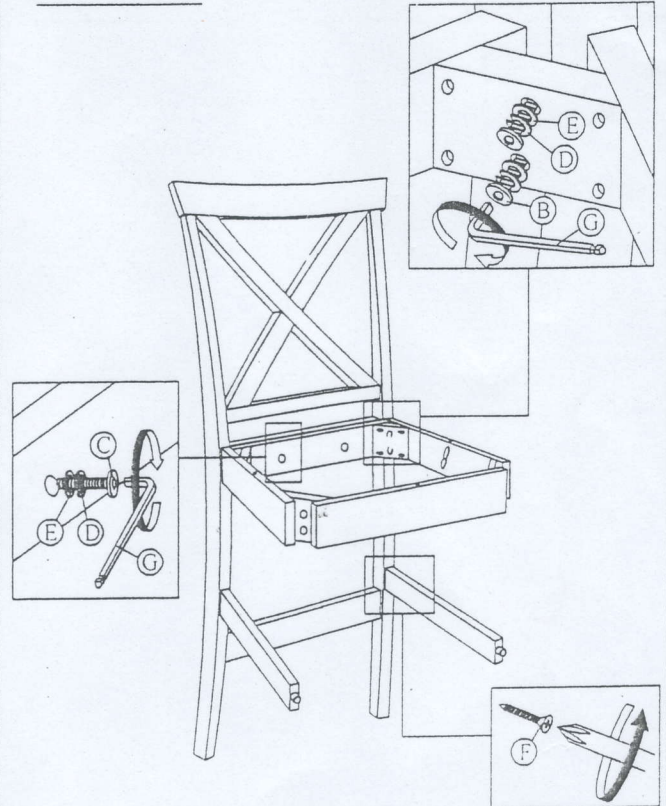

### STEP 2

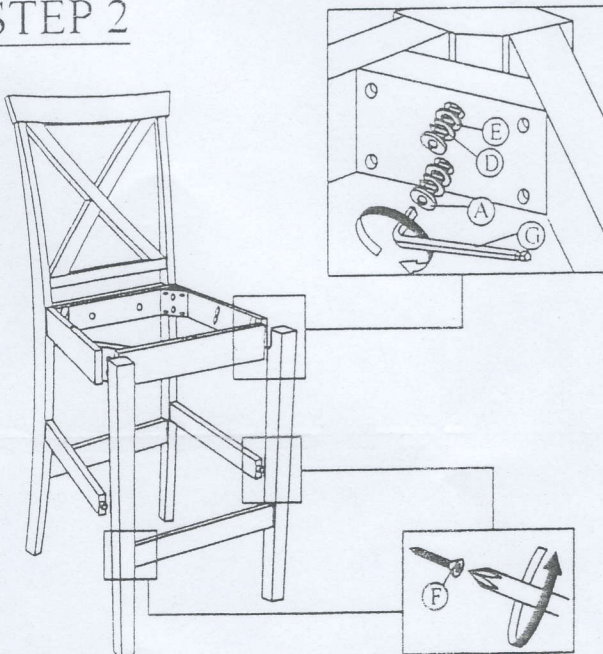

### STEP 3

