

Read this instruction carefully. See hardware and furniture part list for guidance. Be sure all parts are complete, before you assemble. Place all wooden furniture parts on a clean and flat soft surface to prevent from being scratched. Follow the figure to start assembling.

**CAUTIONS :** 1. Do not FULLY - TIGHTEN the nut or nut bolt until all nut or bolt is ready assembled.  
 2. Do not OVER - TIGHTEN the nut or bolt to avoid causing damages to the thread.  
 3. Keep all hardware parts out of reach of children.

**NOTE :** THE LIST AND QUANTITY SHOWN ARE FOR 1 UNIT ASSEMBLY.  
 Tool needed : Screwdriver (not provider).

PART LIST		
ITEM	DESCRIPTION	QTY
A	HEADBOARD	1 PC
B	FOOTBOARD	1 PC
C	SIDE RAIL	2 PCS
D	CENTER RAIL	2 PCS
E	CENTER SUPPORT	3 PCS
F	CENTER SUPPORT LEG	6 PCS
G	BED SLAT	39 PCS
H	BED LEG	4 PCS

HARDWARE LIST		
ITEM	DESCRIPTION	QTY
1	JCBB BOLT M8 x 30mm	4 PCS
2	JCBB BOLT M8 x 40mm	4 PCS
3	JCBB BOLT M8 x 50mm	4 PCS
4	M8 FLAT WASHER	4 PCS
5	M8 SPRING WASHER	4 PCS
6	WOOD SCREW M3.5 x 16mm	12 PCS
7	BED SLAT SIDE FITTER	26 PCS
8	BED SLAT CENTER FITTER	26 PCS
9	M5 ALLEN KEY (BALL SHAPE)	1 PC
10	PVC BLACK WASHER	4 PCS

**STEP 1**

**STEP A**

FRONT VIEW

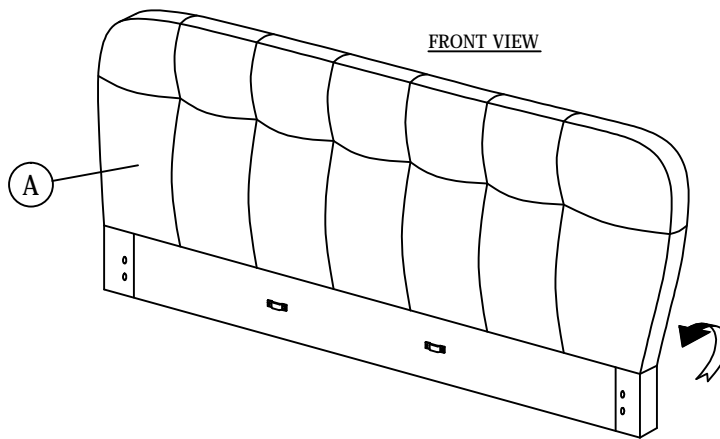

**STEP B**

BACK VIEW

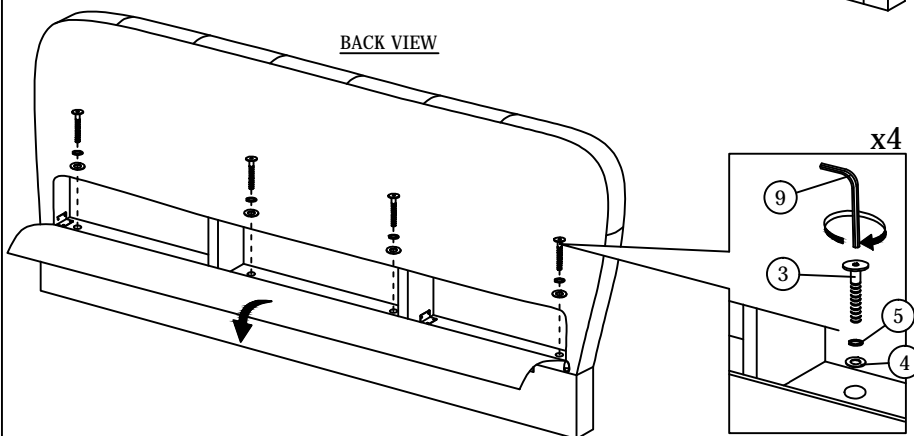

**STEP 2**

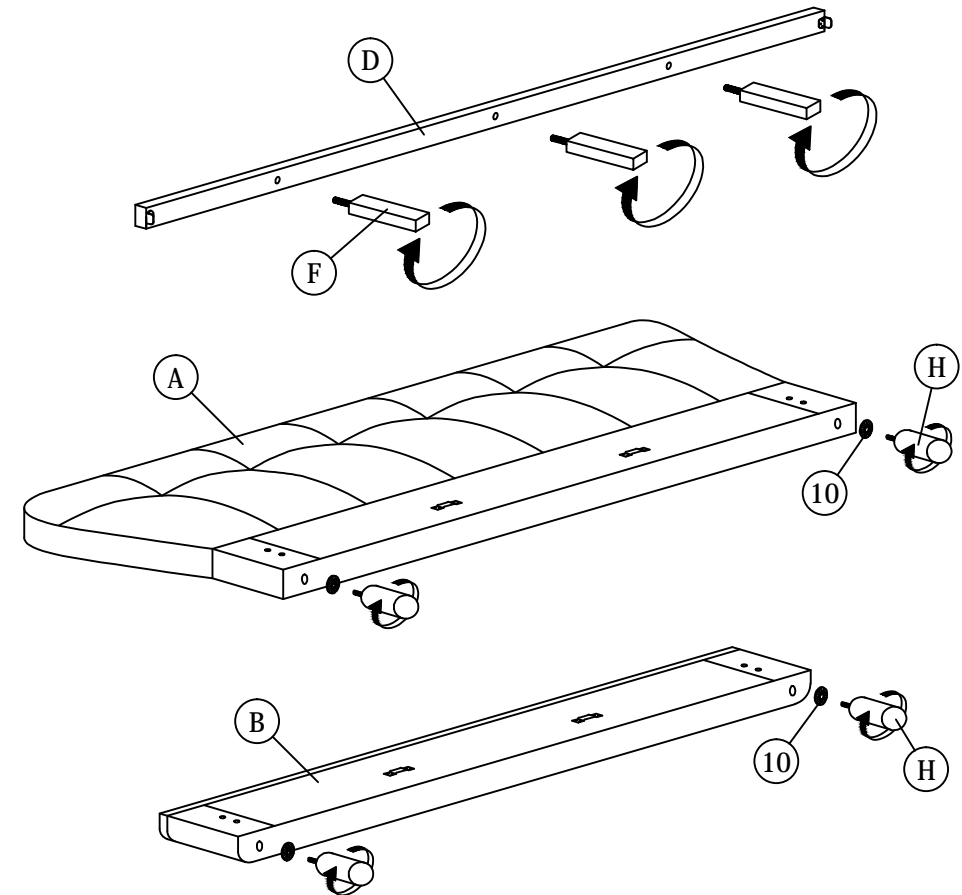

# ASSEMBLY INSTRUCTIONS

## STEP 3

Loosely fit bolt (2) into Headboard (A) as picture shown.

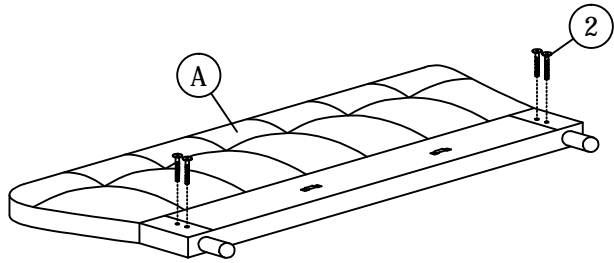

Loosely fit bolt (1) into Footboard (B) as picture shown.

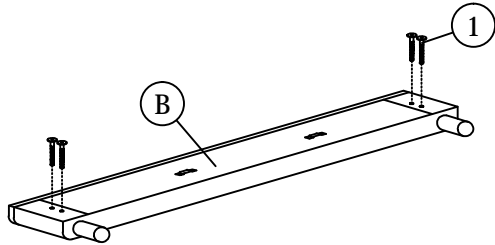

## STEP 4

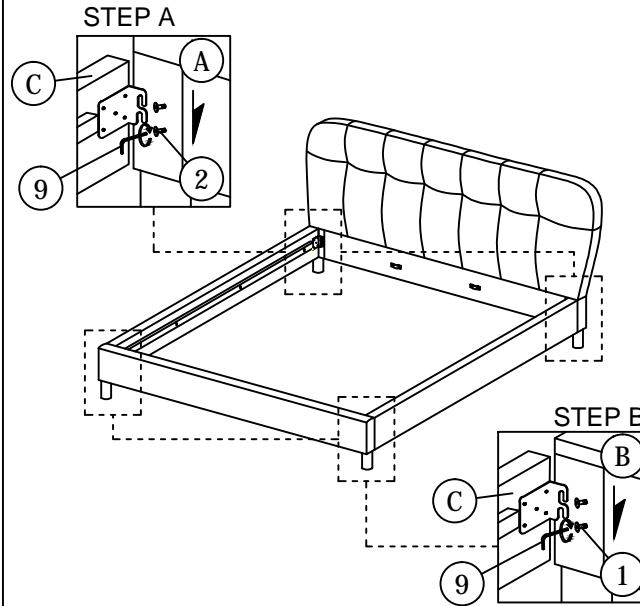

## STEP 5

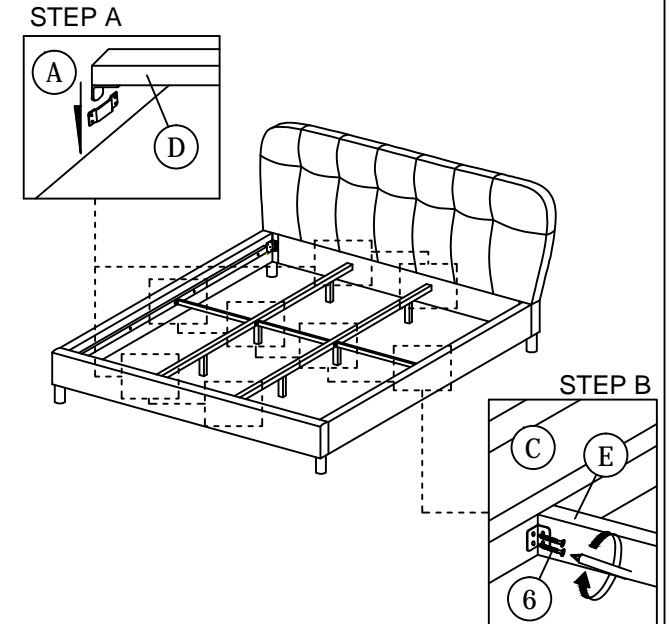

## STEP 6

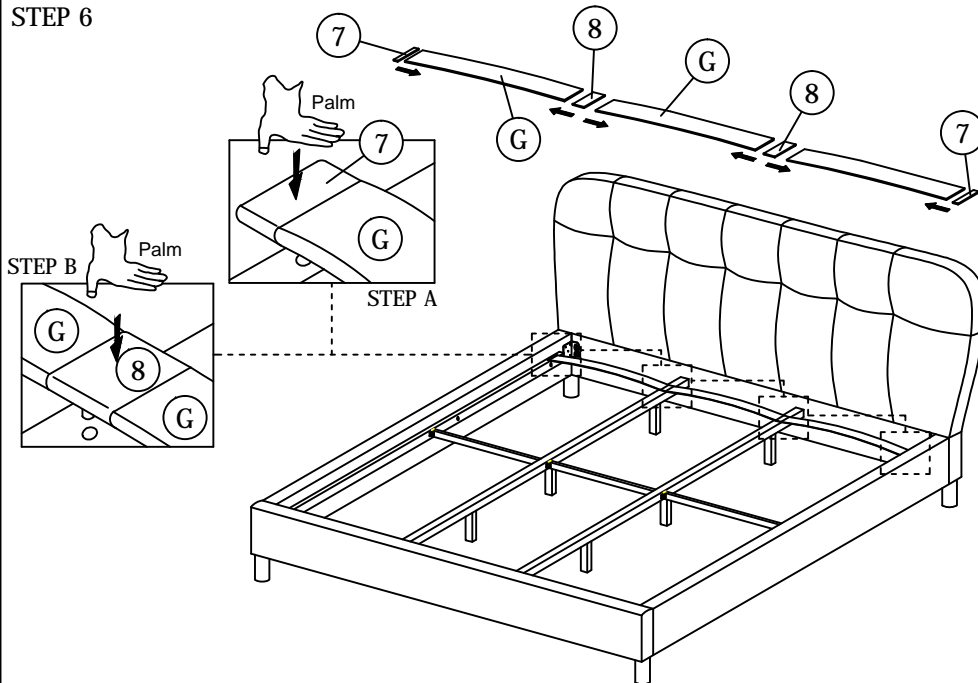

## STEP 7

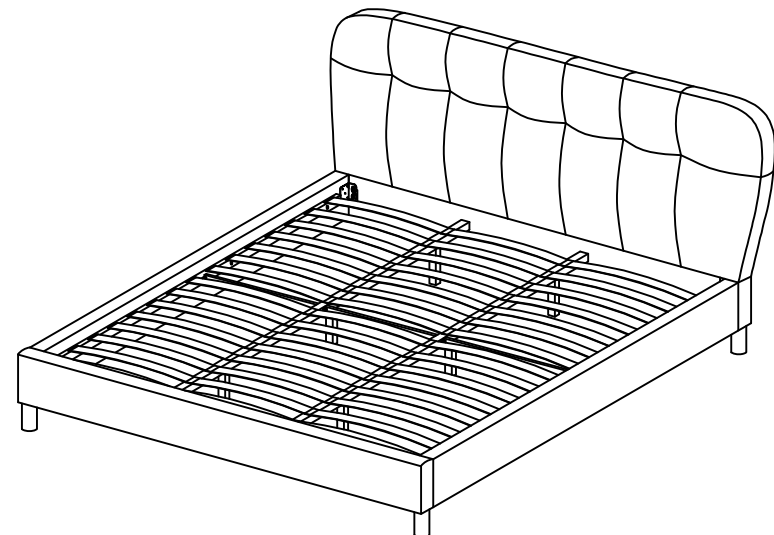

\* When moving the bed position, the center support legs must be adjust to be straight to avoid any broken problem.