

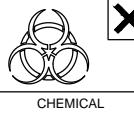

SOFT, DRY CLOTH

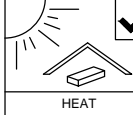

CHEMICAL



HEAT



KEEP DRY



HANDLE WITH CARE

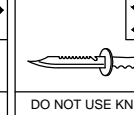

DO NOT USE KNIFE

ASSEMBLY INSTRUCTION

MODEL : SB 003

DESCRIPTION : SIDEBORD WITH 2 DOOR AND 1 DRAWER

HARDWARE

A WOOD DOWEL M8 X 25MM 24	B B1 MINIFIX 5654+5546 16 SETS B2 QUICKFIT CAP B3	C 16MM CB SCREW M3.5X16MM 28	D 38MM CB SCREW M4X38MM 13	E NAIL 5/8 30	F PVC NAIL WITH 5/8 4	G L KEY 1	H H1 HANDLE 7050 -96MM 3 H2 HANDLE SCREW M4X19MM 6	I HINGES 5/8 4	J J1 DRAWER SLIDE 14" 1 SET J2	K PVC LEG 50MM 1
---	--	---	---	--------------------------------	--	----------------------------	---	---------------------------------	---	-----------------------------------

PART LIST

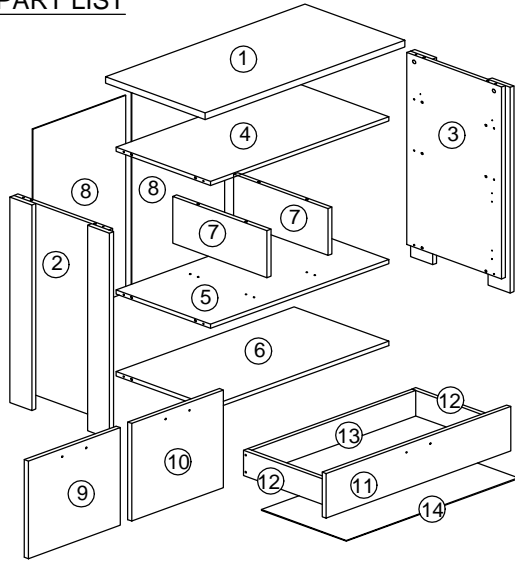

STEP 1

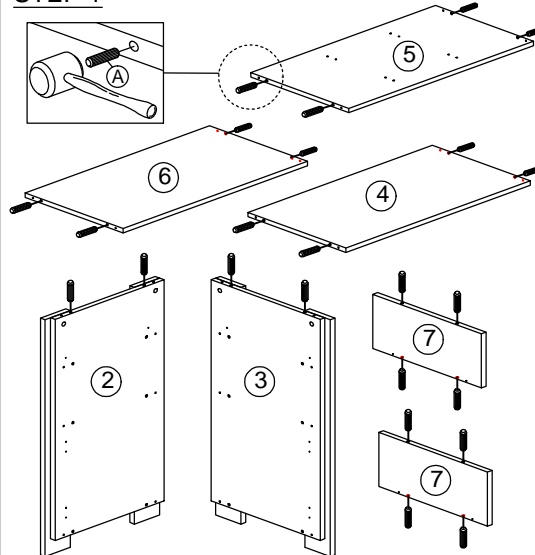

STEP 2

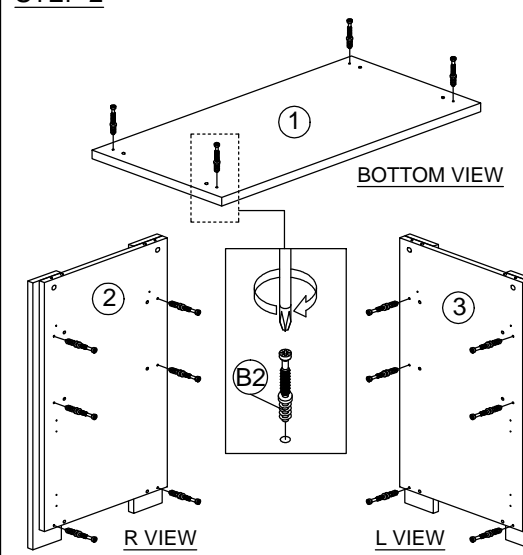

STEP 3

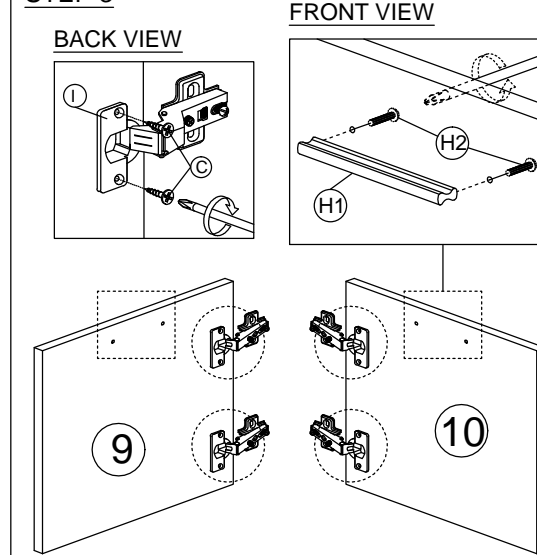

STEP 4

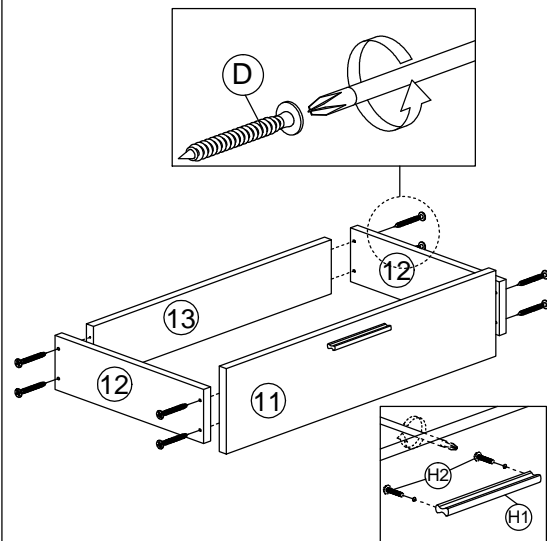

STEP 5

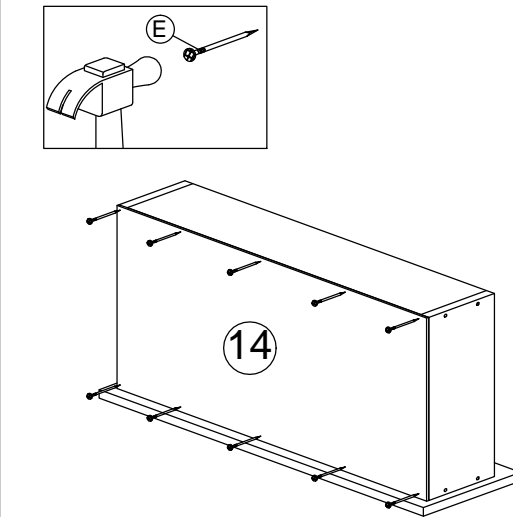

STEP 6

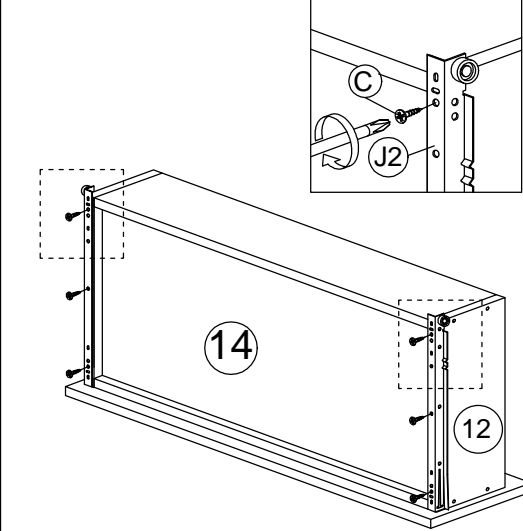

STEP 7

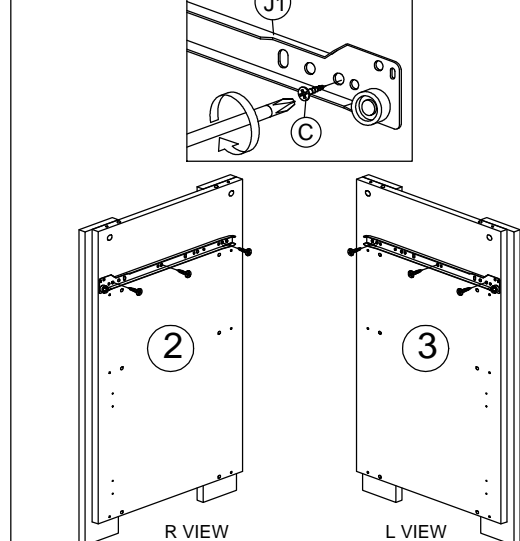



SOFT, DRY CLOTH



CHEMICAL

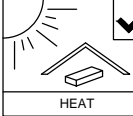

HEAT



KEEP DRY



HANDLE WITH CARE

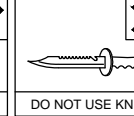

DO NOT USE KNIFE

ASSEMBLY INSTRUCTION

MODEL : SB 003

DESCRIPTION : SIDEBORD WITH 2 DOOR AND 1 DRAWER

STEP 8

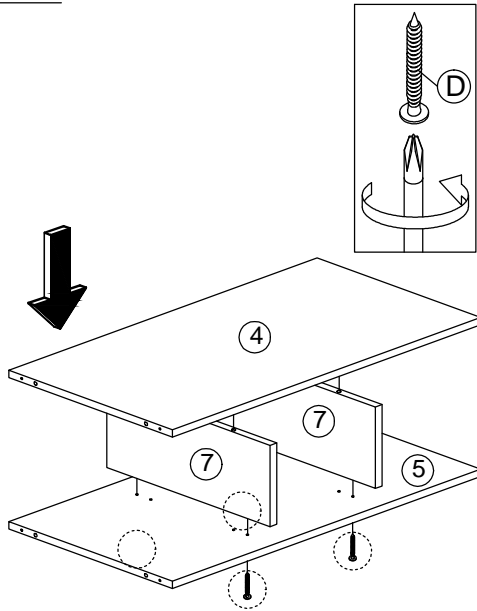

STEP 9

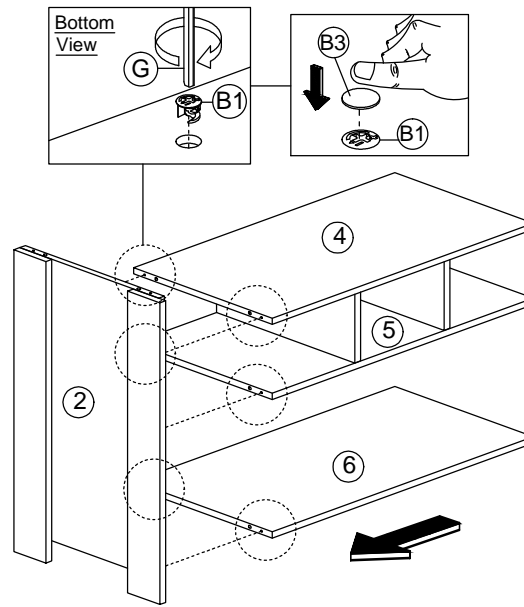

STEP 10

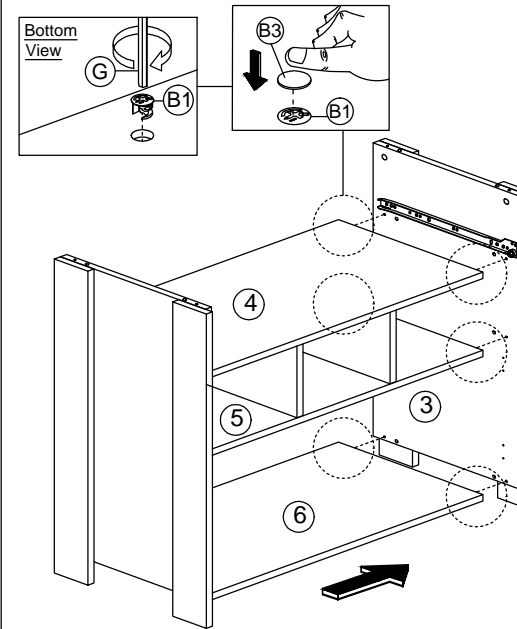

STEP 11

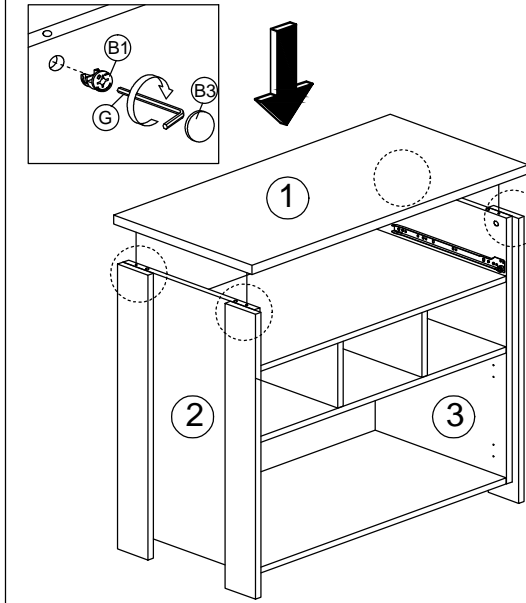

STEP 12

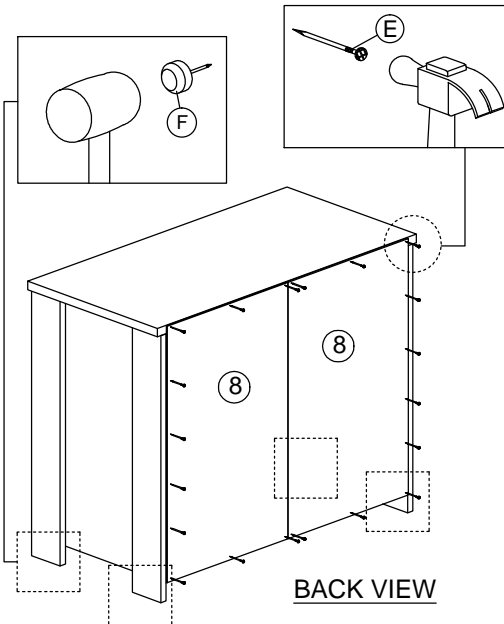

STEP 13

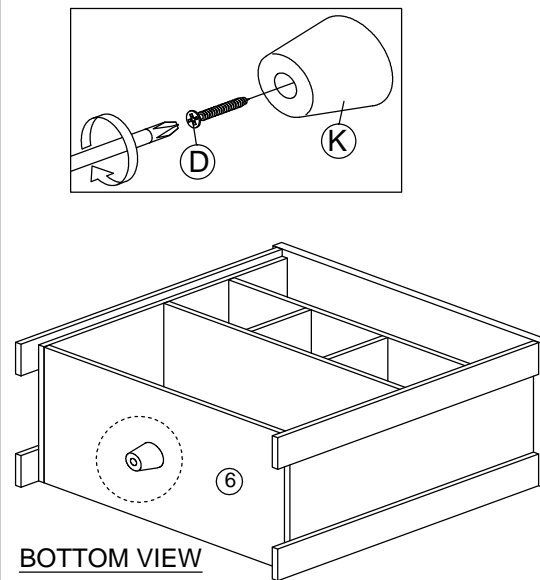

STEP 14

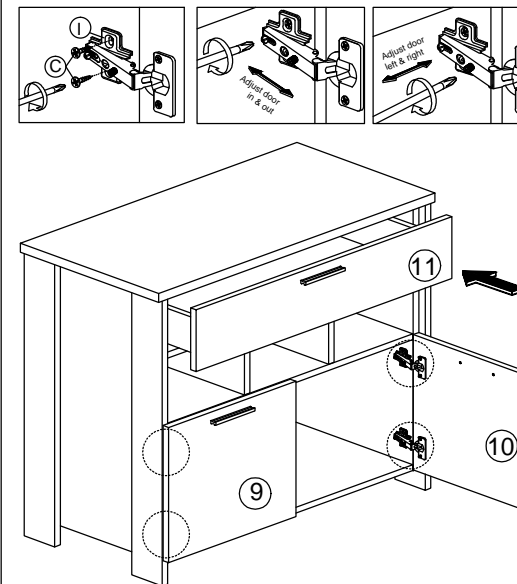

COMPLETED

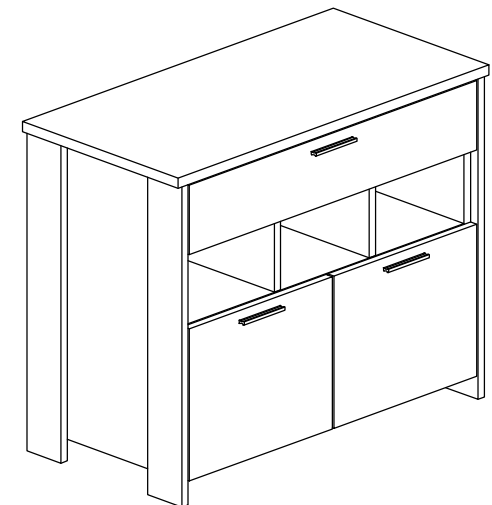

Installation of Anti-Tip Restraint

Kit includes:

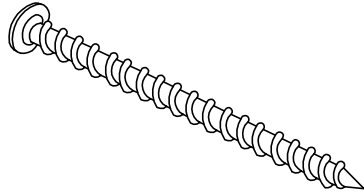

A (x1)
Long screw

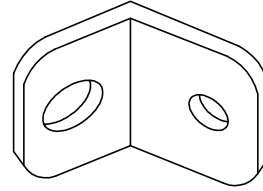

B (x2)
Mounting bracket

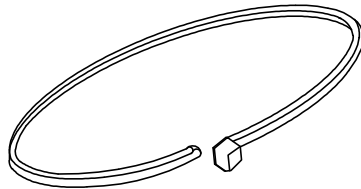

C (x1)
Restraint strap

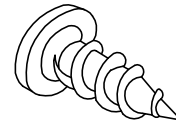

D (x1)
Short screw



WARNING



Serious or fatal crushing injuries can occur from furniture tip-over. To help Prevent tip-over:

- Install tip-over restraint provided
- Place heaviest items in the lower drawers
- Do not set TV's or other heavy objects on top of this product
- Never allow children to climb or hang on drawers, doors or shelves
- Never open more than one drawer at a time
- Do not defeat or remove the drawer interlock system

Use tip-over restraints may only reduce but not eliminate the risk of tip-over.

IMPORTANT: Use of this safety kit is mandatory. This restraint is not a substitute for proper adult supervision. Failure to detach this restraint before moving furniture may result in injury and damage.

FITTING OF ANTI-TIP SAFETY STRAP

STEP 1:

- Attach the mounting bracket (b) to the furniture in the solid part below the top panel a few inches away from the side of the unit.
- Screw (d) through the smallest hole of (b).

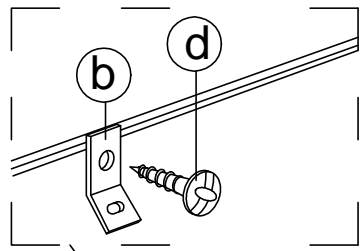

BACK SIDE OF TOP PANEL

WALL

FURNITURE

STEP 2:

- Locate a stud in behind the have to
- Place the other mounting bracket (b) on the wall stud 2 inches below the mounting bracket secured to the back of your unit.
- Attach to the wall stud using (a) through the smaller hole of (b).

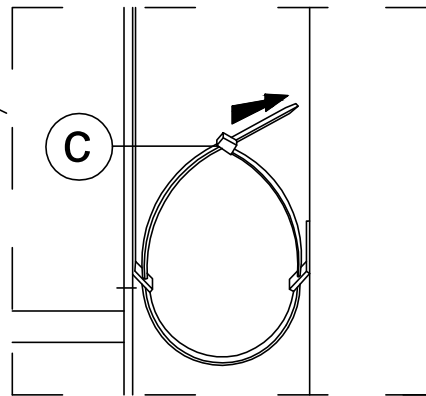
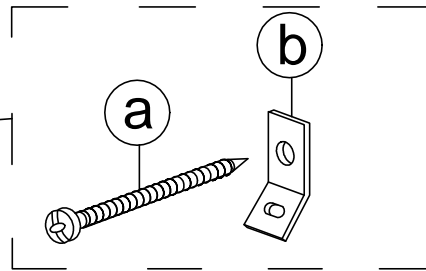

STEP 3:

- Repeat the same step a few inches away from the other side of the unit.
- Place the furniture into position so both mounting brackets are vertically in line.
- Lace the end of the restraint strap through the larger holes in each mounting bracket.
- Secure the straps and lock into place.

