

# 006-1 Queen Bed

## Assembly Instructions

WI-1220

### 1 Assembled View

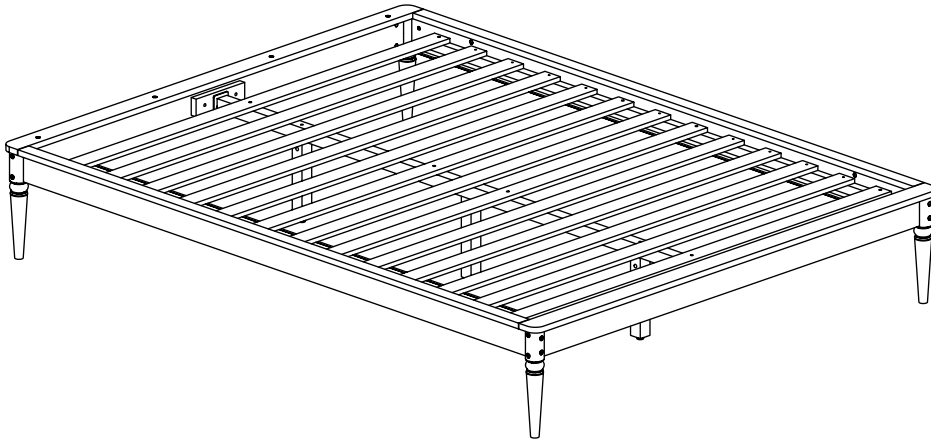

**Note:** Do not assemble using power tools. This can cause the bolts to be overtightened

### 2 Parts List

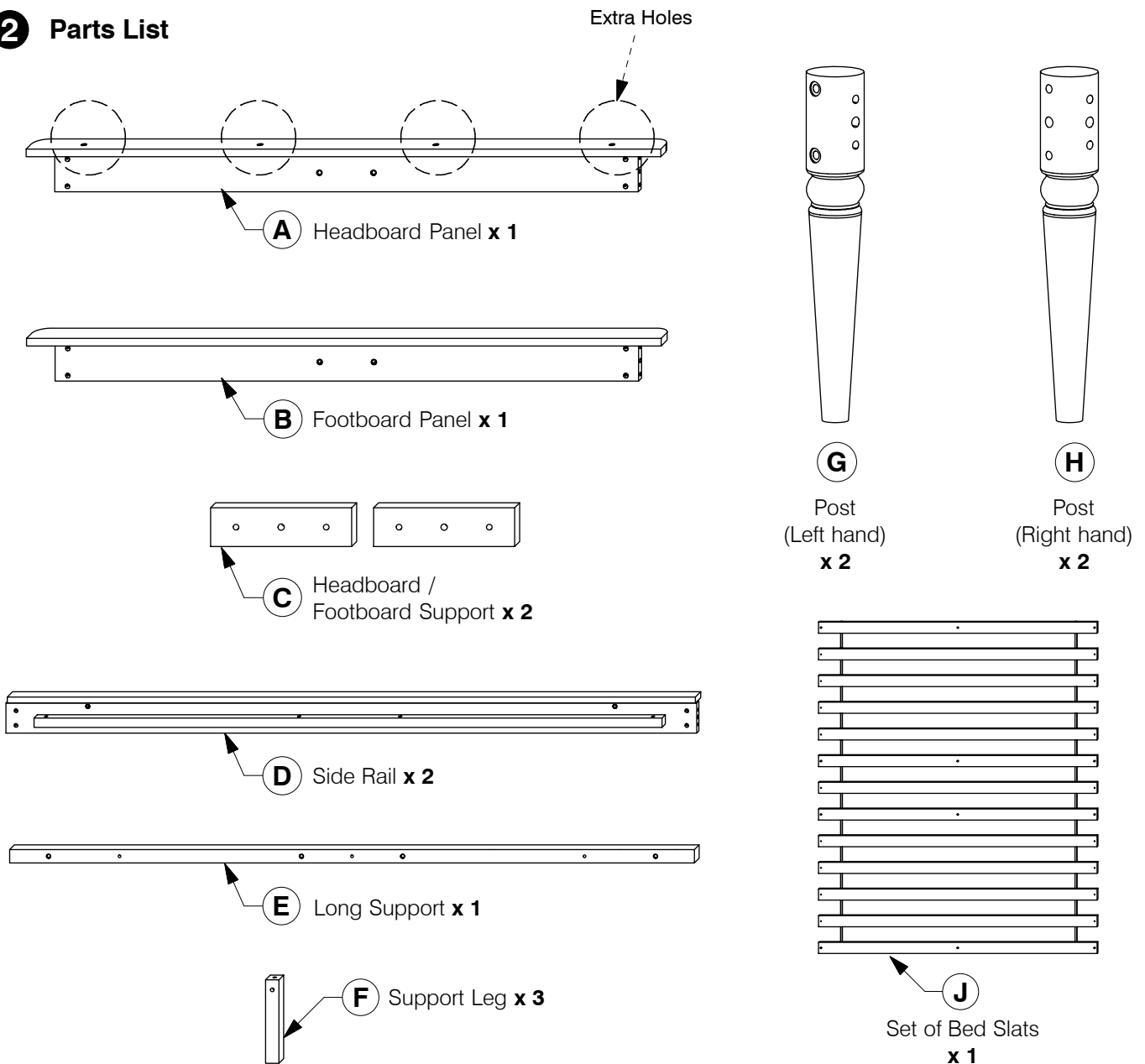

# 006-1 Queen Bed

## Assembly Instructions

WI-1220

### 3 Hardware List



1 M4 Allen Key  
x 1

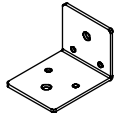

2 Center Rail  
Bracket x 2

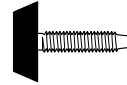

3 Adjustable  
Foot x 3



4 Wood Screw  
(M4 x 32mm)  
x 18



5 Wood Dowel  
(10 x 40mm) x 8



6 Barrel  
Nut x 19



7 M6 x 15mm JCB  
x 4



8 M6 x 30mm JCB  
x 4



9 M6 x 40mm JCB  
x 12



10 M6 x 90mm JCB  
x 19

### 4 Assembled the Support Legs (F) to the Long Support (E).

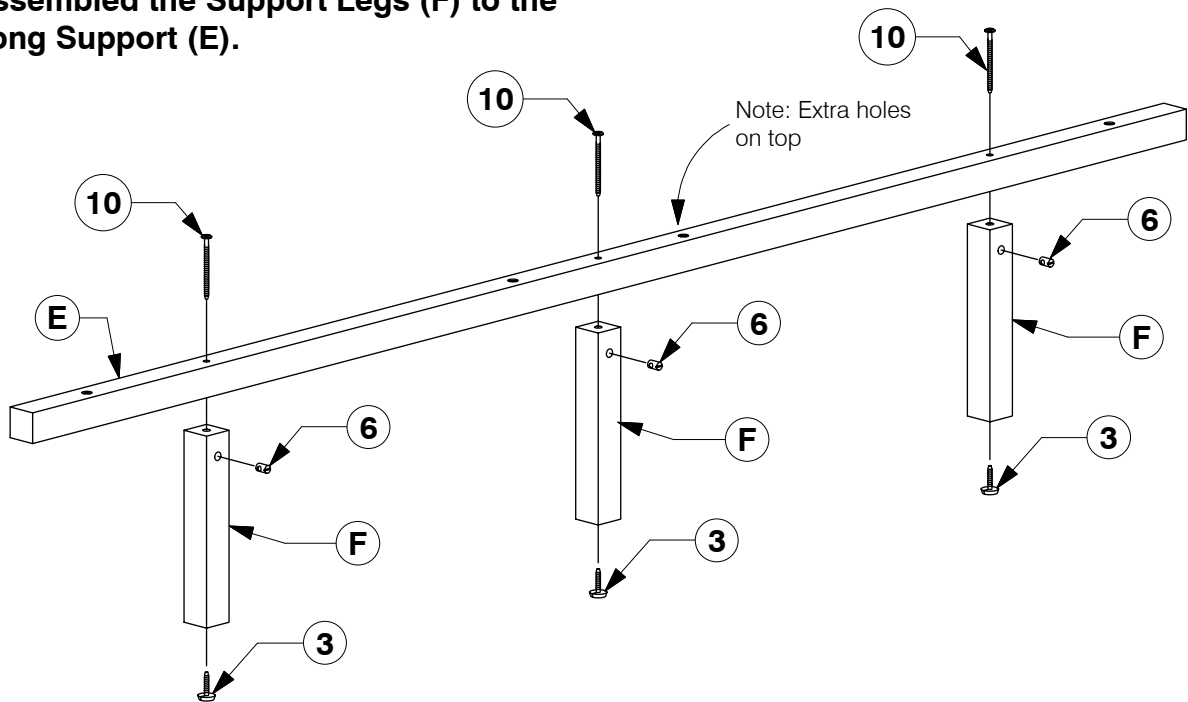

### 5 Fit the Center Rail Bracket to the Head / Footboard Support (C).

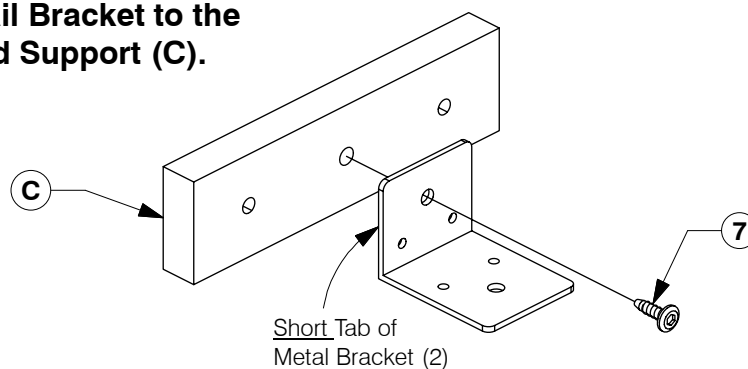

x2

# 006-1 Queen Bed

## Assembly Instructions

WI-1220

- 6** Assemble the Post (G & H) and Head / Footboard Support (C) to the Headboard Panel (A).

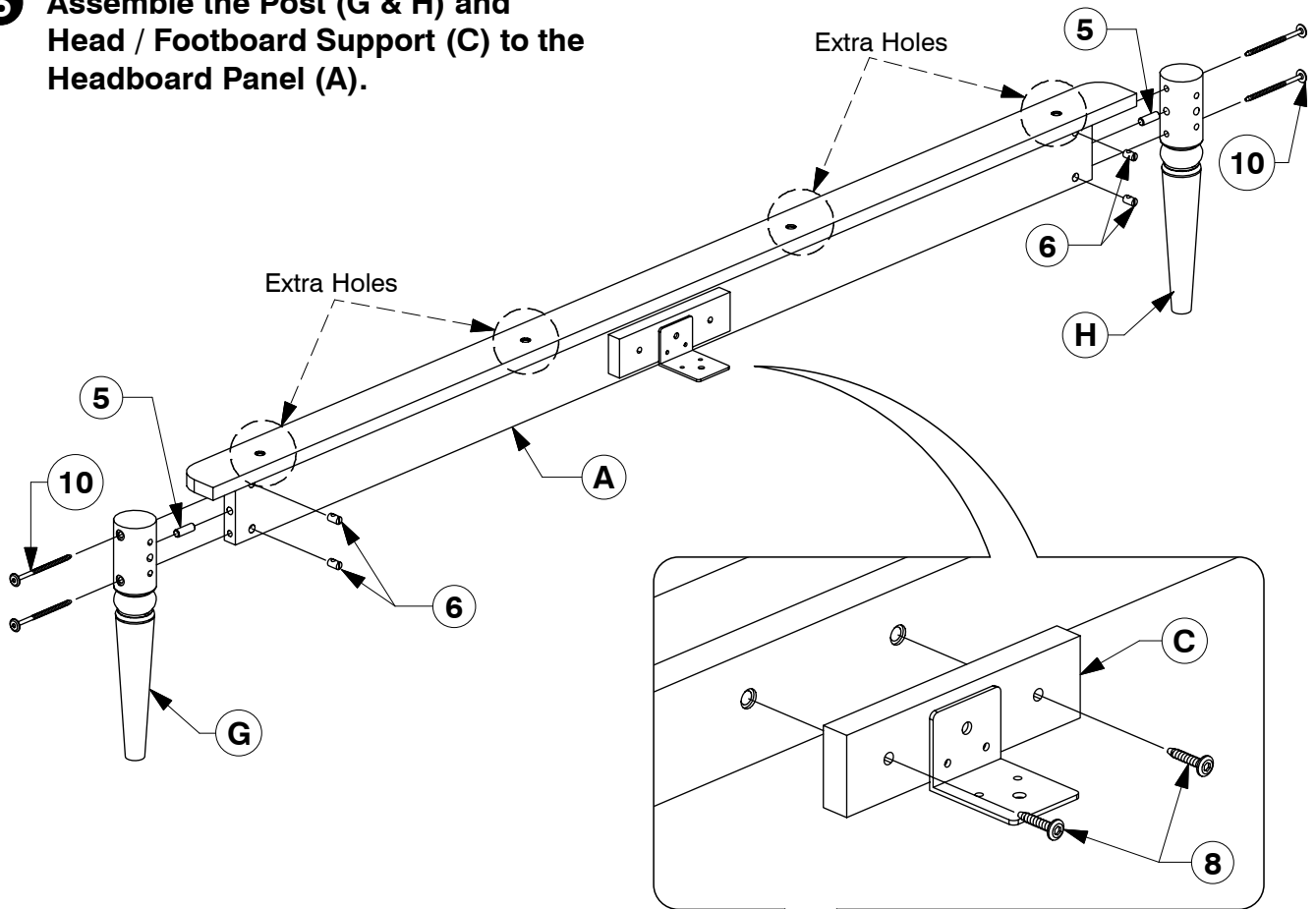

- 7** Assemble the Post (G & H) and Head / Footboard Support (C) to the Footboard Panel (B).

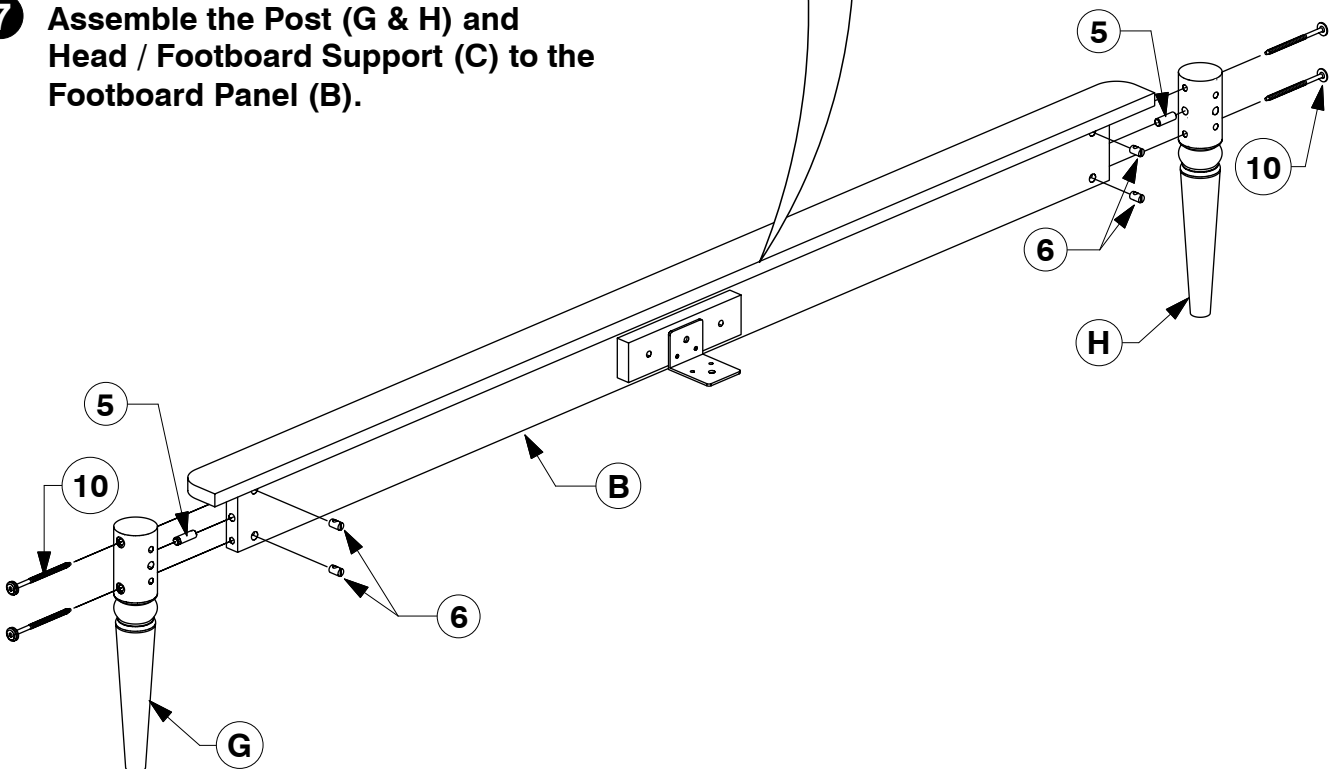

# 006-1 Queen Bed

## Assembly Instructions

WI-1220

- 8 Assemble the Side Rail (D) to the Headboard & Footboard Panel (A & B).**

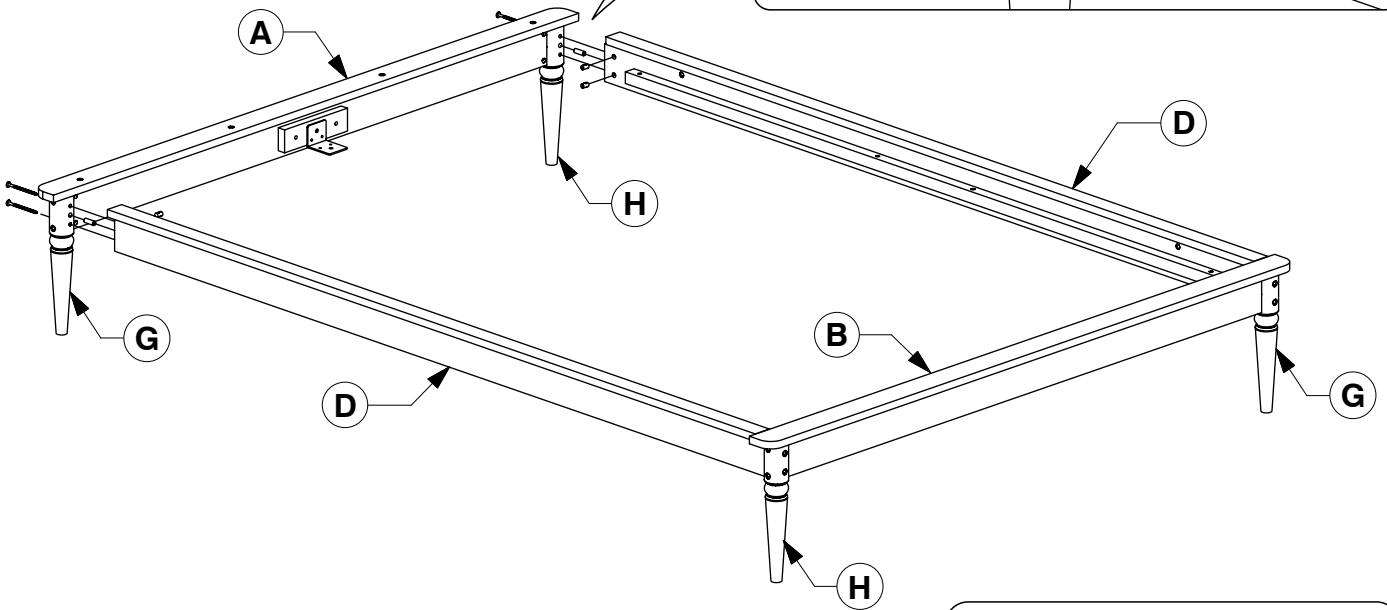
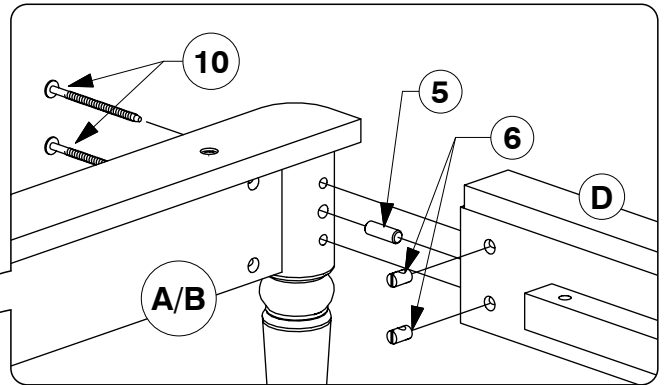

- 9 Bolt the Long Support (E) to the Center Rail Brackets (2) on the Headboard & Footboard Panel (A & B).**

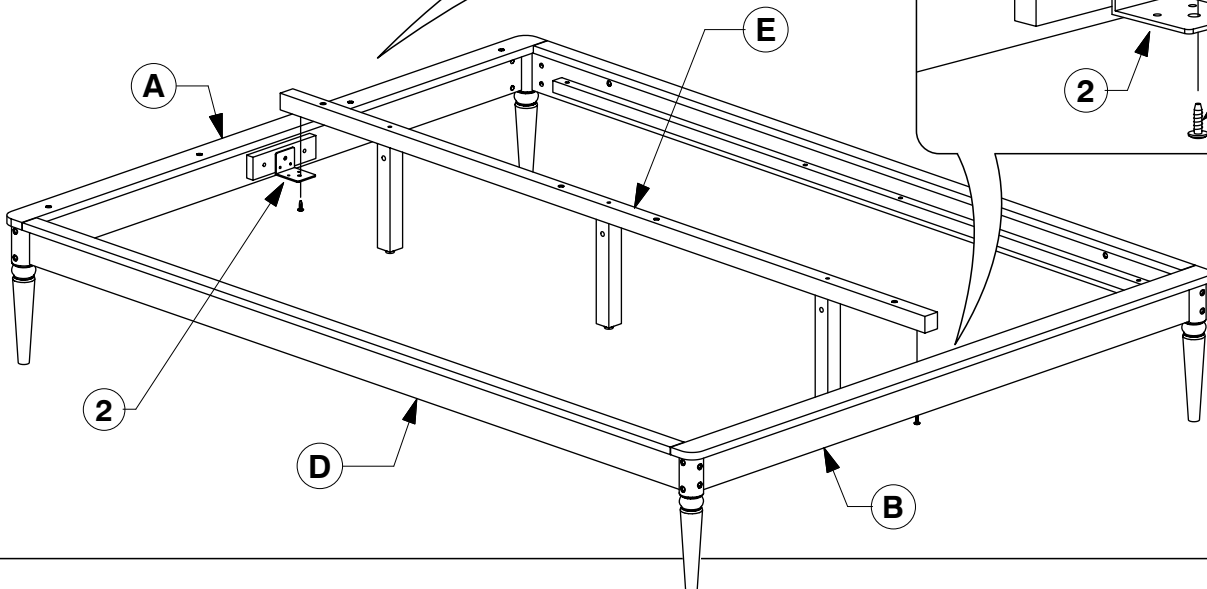
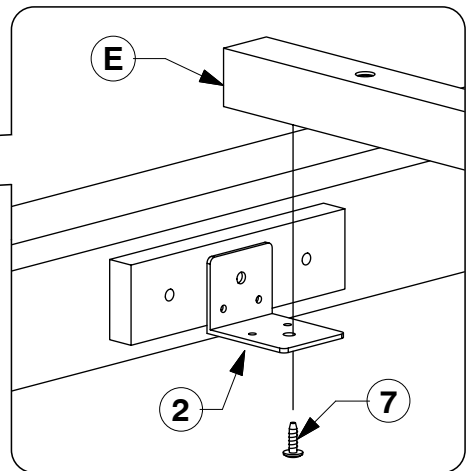

# 006-1 Queen Bed

## Assembly Instructions

WI-1220

- 10** Bolt the Bed Slats (J) to the Side Rail (D).

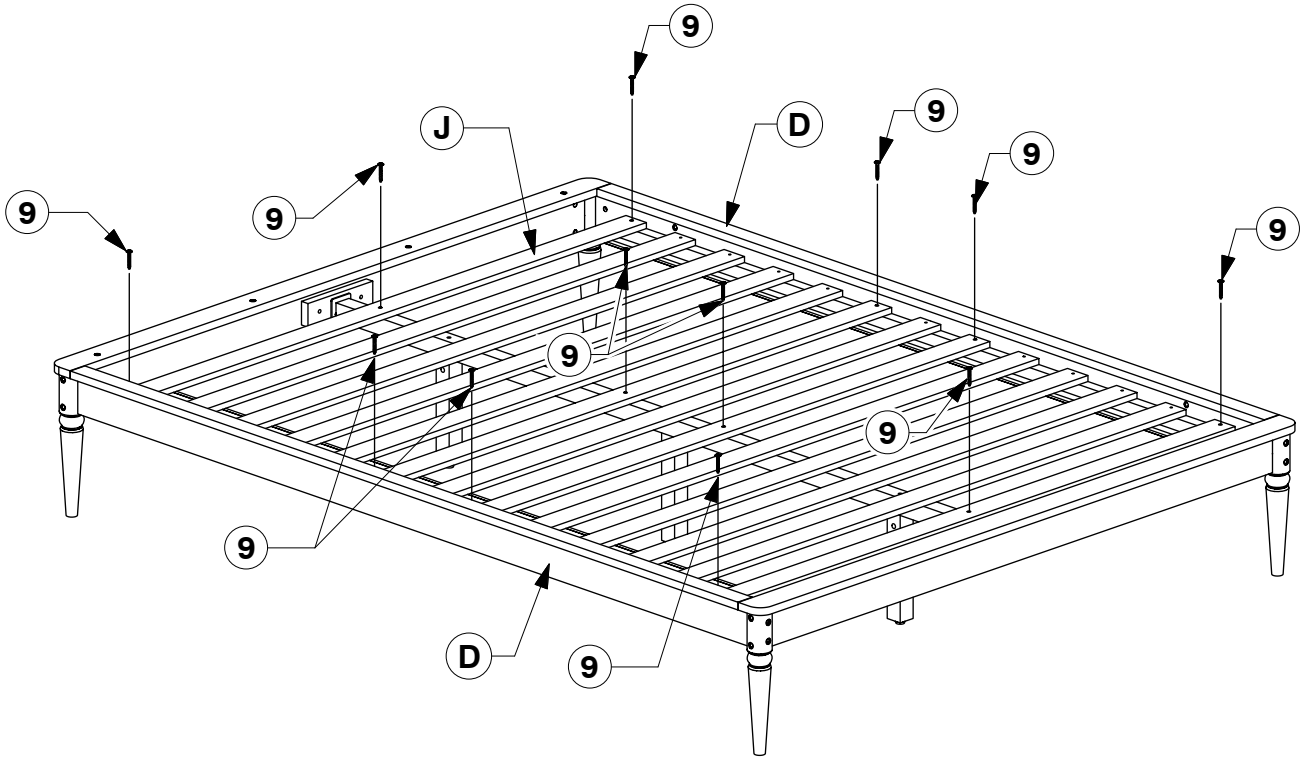

- 11** Screw the Bed Slats (J) to the Side Rail (D).

