

MODEL : CF 9172 (3)

ASSEMBLY INSTRUCTION

A	Arm A1	A2	2 pcs
B	Slat 13 Pcs		1 pc
C	Back Panel		1 pc
D	Side Rail		1 pc
E	Trundle Front Panel (FU)		1 pc
F	Trundle Back Panel		1 pc
G	Trundle Side Panel		2 pcs
H	Slat 13 Pcs		1 pc
I	Wooden Block		4 pcs
Packing Hardware			
1	M5 x 70 mm		1 pc
2	M4 x 65 mm		1 pc
3	CSK M4 x 32mm		64 pcs
4	CSK M4 x 16 mm		24 pcs
5	JCBC M6 X 50		4 pcs
6	Flat Washer		4 pcs
7	Roller		6 pcs
8	JCBB M8 X 20		12 pcs

Step 1 : Attach the back panel (C) to arm (A). Attach side rail (D) to arm (A) by pushing the bracket down to fit it. Tighten with Allen Key (1).

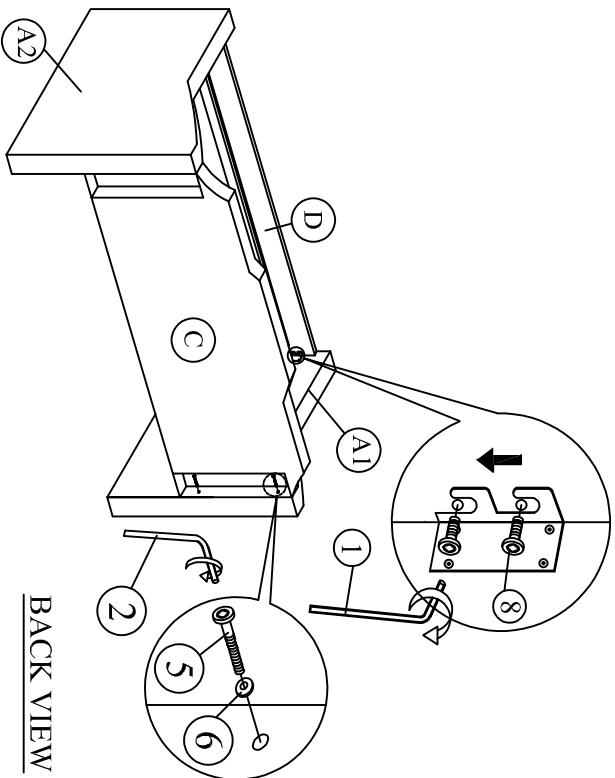

BACK VIEW

Step 2 : Tighten the slats with CSK screw (3). The distance of the slats should be sufficient to obtain desirable bed stability.

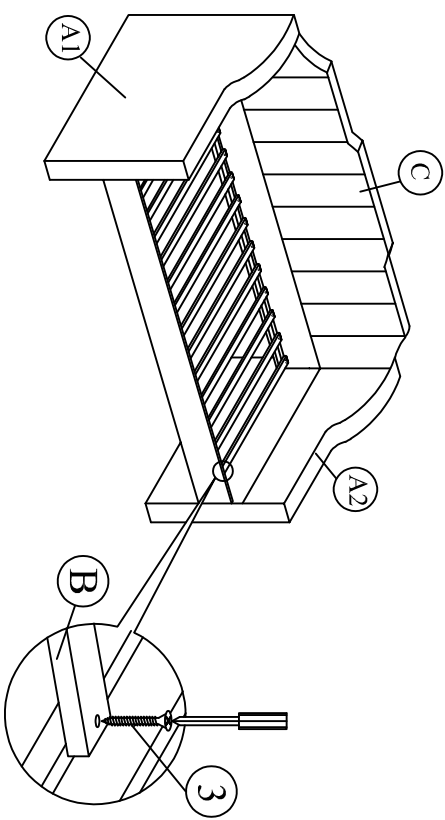

Step 3 : Attach trundle side panel (G) and trundle front panel (E) to trundle back panel (F) by pushing the bracket down to fit it.

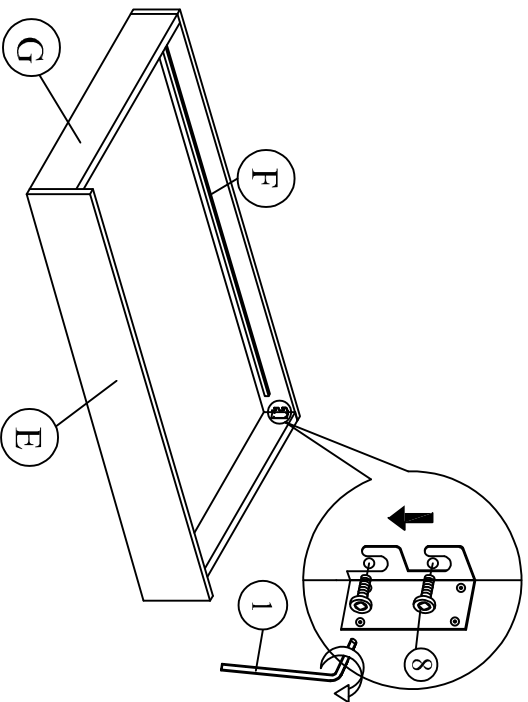

Step 4 : Affix the roller (7) to the slat (H) follow the marking on the slat (H).

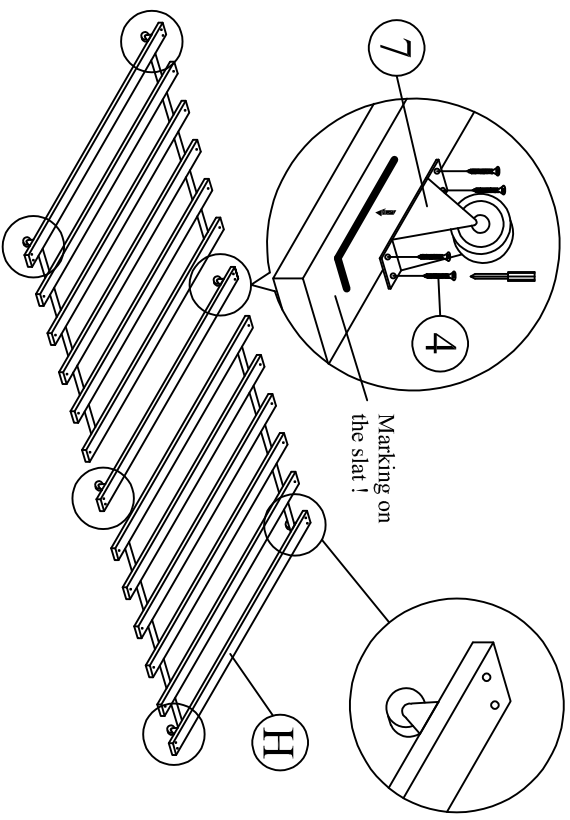

Step 5 : Place the wooden blocks (I) at the corner of the trundle and fix the slat (H) to the side rail at (D) & (E).

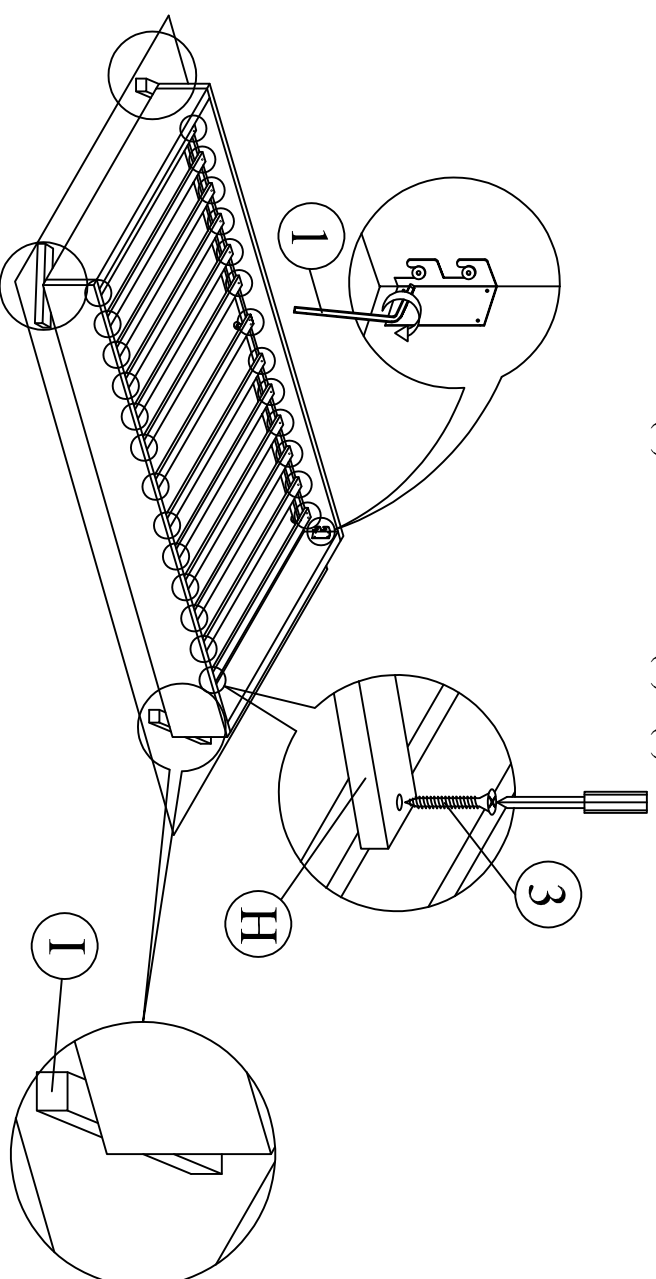

Step 6 : Assembly is complete.

