

The parts and hardware below have been included for assembly:

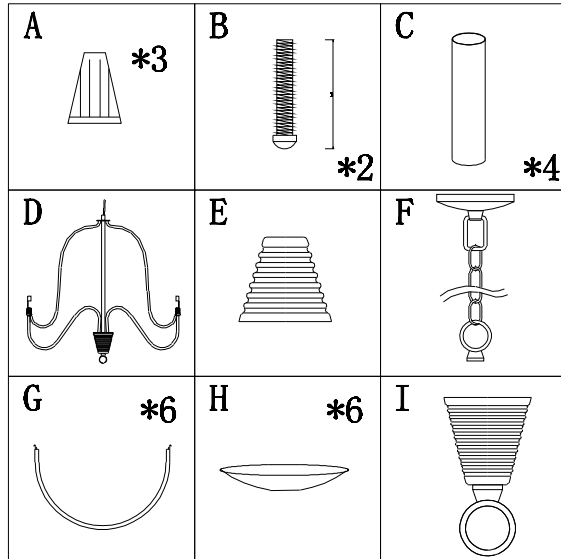

Assembly Steps:

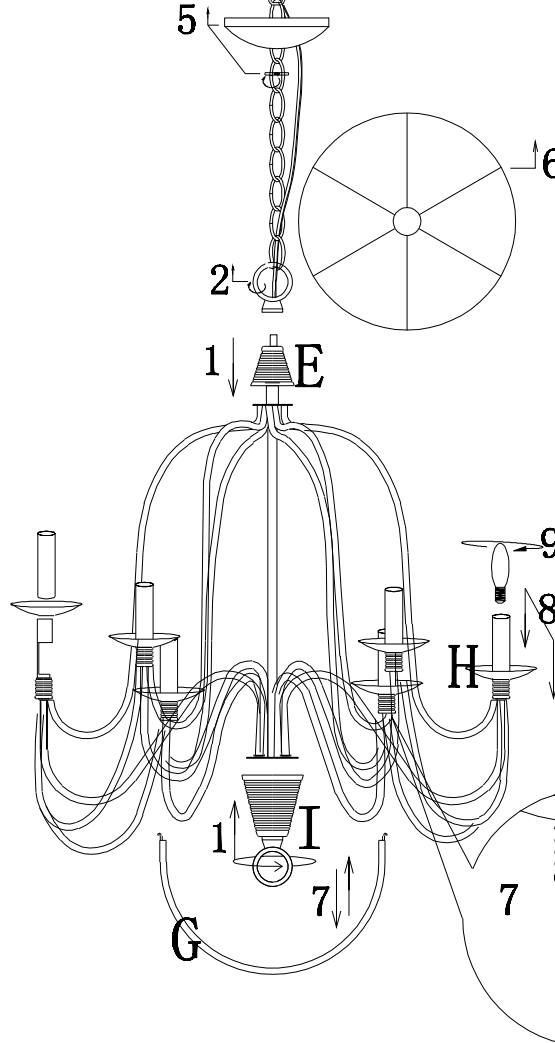
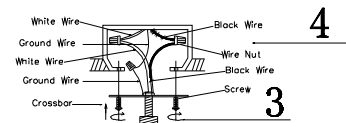
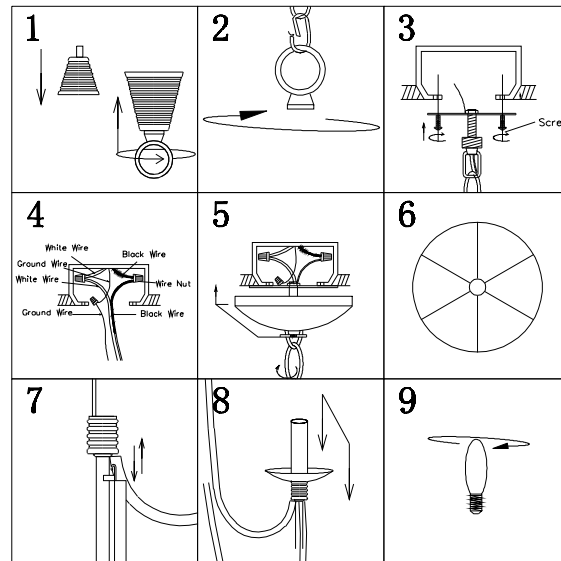

Assembly Instruction:

1. Take out fixture body D, install E and I on the lamp body D separately like as picture.
2. Rotate and connect chain F and fixture body D.
3. Put machine screw B through mounting strap and lock on ceiling.
4. Use spiral hat A to screw HOT wire(black wire) of lamp with black wire from supply; screw Neutral wire(white wire) of lamp with white wire from supply; and screw Ground wire of lamp with Ground wire from supply.
5. Push up canopy and lock it with crystal ring.
6. Divide body fixture D into six equal parts.
7. Hang pipe G between lamp arm separately.
8. Install the tray(H) and the drivepipe(C).
9. Install the bulbs(bulb not include).

Specification:

Overall Dimension: 26.4*25.2"
Rated Voltage: 110V60Hz-6*40W

WARNING:

The light fixture can only be used indoors, please cut off power before installing the light fixture