

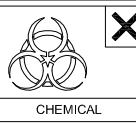

SOFT, DRY CLOTH

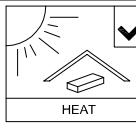

CHEMICAL



HEAT



KEEP DRY



HANDLE WITH CARE



DO NOT USE KNIFE

ASSEMBLY INSTRUCTION

MODEL : TV 834133

DESCRIPTION : TV CABINET

HARDWARE

| | | | | | | | | | | | | |
|--|---|----------------------------------|------------------------------|--|---------------------------------------|--|---|--------------------------------------|--|---|---|--|
| A WOOD DOWEL 8 X 25 1X28 | B 16MM CB SCREW M3.5X16MM 1X84 | C NAIL 5/8 1X52 | D L KEY 1X1 | E E1 E2 E3 MINIFIX 5654+5546 QUICKFIT CAP 20 SETS | F M502 L BRACKET 1X2 | G HANDLE 5540 -96MM 1X6 | H 19MM HANDLE SCREW M4X19MM 1X12 | I HINGES 2/8 8 SETS | J 50MM CSK CAP WOOD M6X50MM 1X4 | K 38MM CB SCREW M4X38MM 1X16 | L L1 L2 DRAWER SLIDE 14" 2 SETS | M MIRROR BRACKET 1X24 |
|--|---|----------------------------------|------------------------------|--|---------------------------------------|--|---|--------------------------------------|--|---|---|--|

PART LIST

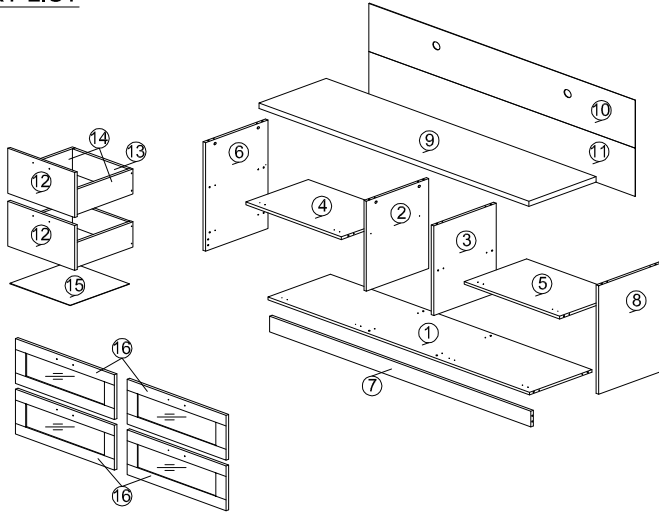

STEP 1

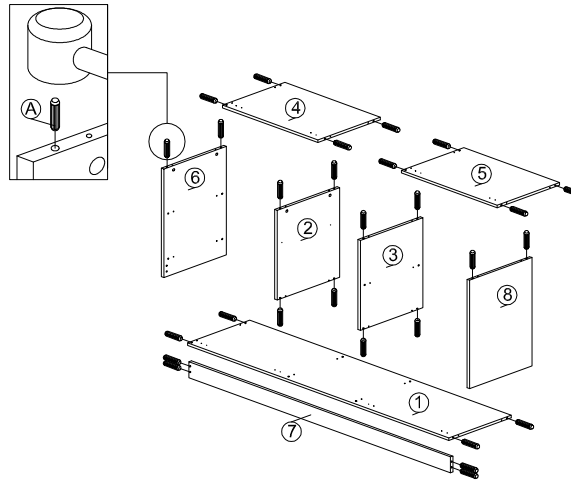

STEP 2

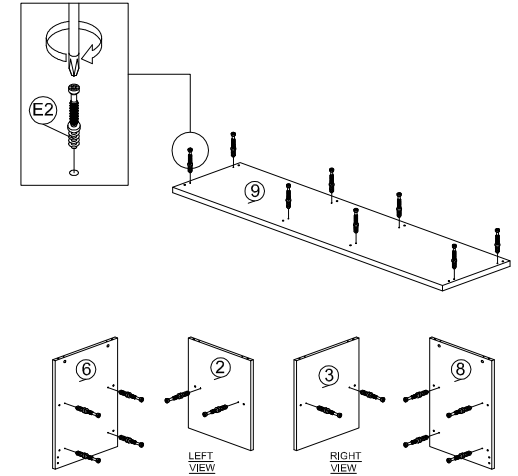

STEP 3

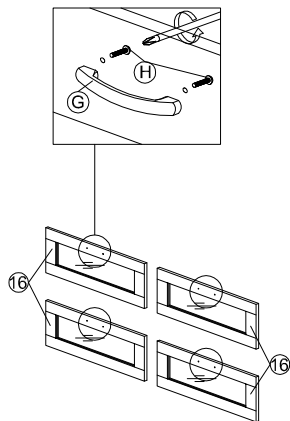

STEP 4

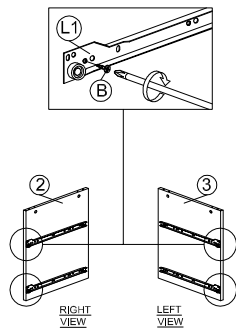

STEP 5

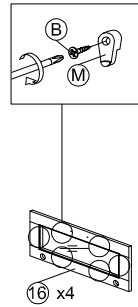

STEP 6

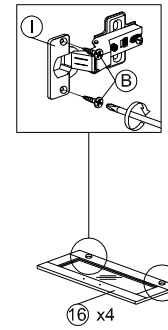

STEP 7

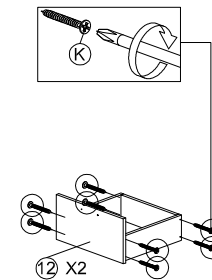

STEP 8

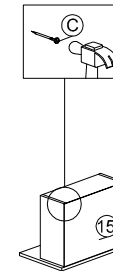

STEP 9

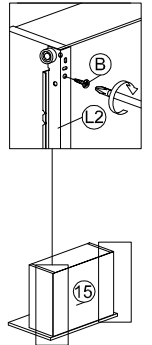



SOFT, DRY CLOTH

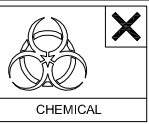

CHEMICAL

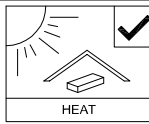

HEAT



KEEP DRY



HANDLE WITH CARE



DO NOT USE KNIFE

ASSEMBLY INSTRUCTION

MODEL : TV 834133

DESCRIPTION : TV CABINET

STEP 10

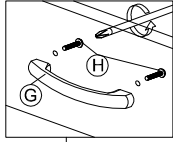

12 X2

STEP 11

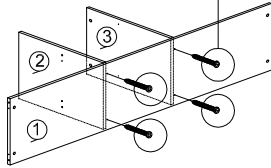
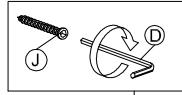

STEP 12

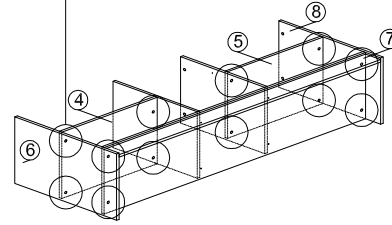
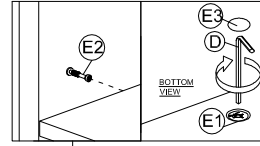

STEP 13

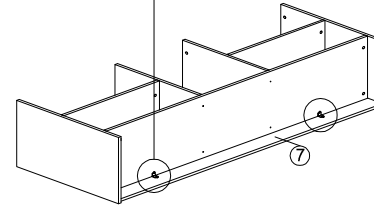
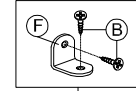

STEP 14

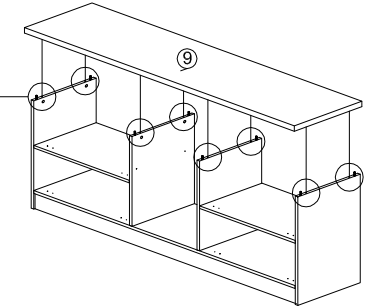
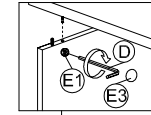

STEP 15

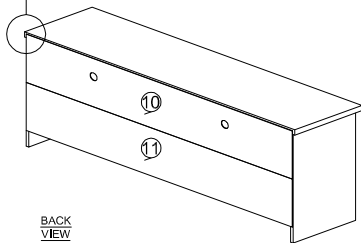
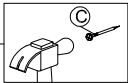

BACK VIEW

STEP 16

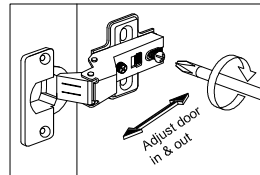

Adjust door in & out

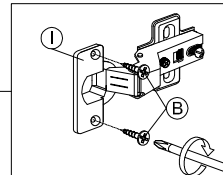

Adjust door left & right

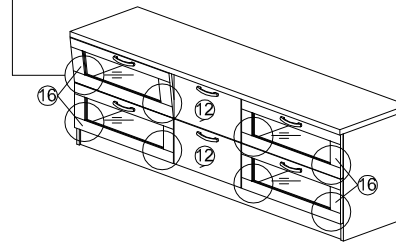
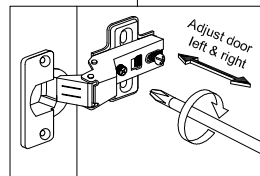

COMPLETED

