

# ASSEMBLY INSTRUCTION

MODEL : Vera Day Bed - HB,FB+SR

NO	PART LIST	QTY
1	HB	1pc
2	FB	1pc
3	BACK REST	1pc
4	FRONT RAIL	1pc
5	BACK RAIL	1pc
6	SLAT 7pcs	2pcs
7	LEG	4pcs
NO	HARDWARE LIST	QTY
A	SCREW M4 x 32mm	8pcs
B	JCBB SCREW M8 x 20mm	8pcs
C	JCBC SCREW M6 x 35mm	4pcs
D	JCBC SCREW M6 x 50mm	3pcs
E	SPRING WASHER 1/4" x Ø12mm	3pcs
F	FLAT WASHER 1/4" x Ø19mm	3pcs
G	L - KEY M5 x 65mm	1pc
H	L - KEY M4 x 65mm	1pc

**STEP 1** Begin assembly by attaching each Leg (7) to the bottom of the HB (1) & FB (2) securing with 2 Allen Bolt (C) per panel.

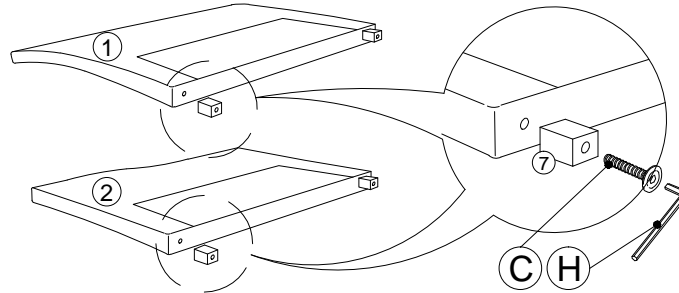

**STEP 2** Attach the Front Rail (4) and Back Rail (5) to the HB (1) & FB (2) aligning holes and securing with 2 Allen Bolts (B) per each end. (DO NOT FULLY TIGHTEN BOLTS FOR THIS STEP)

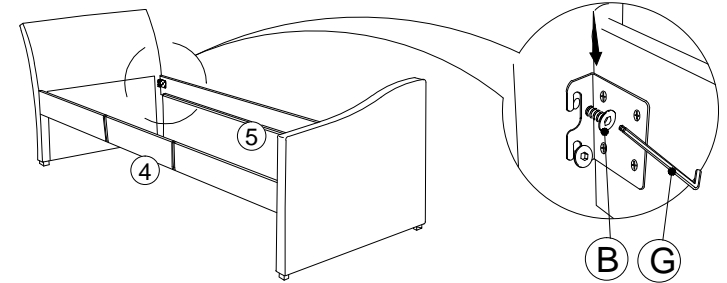

**STEP 3** Attach the Back Rest (3) to the back of each HB (1) & FB (2) by aligning the hole and securing with 2 Allen Bolt (D), 2 Spring Washer (E), 2 Flat Washer (F) from the back side per each end. (DO NOT FULLY TIGHTEN BOLTS FOR THIS STEP)

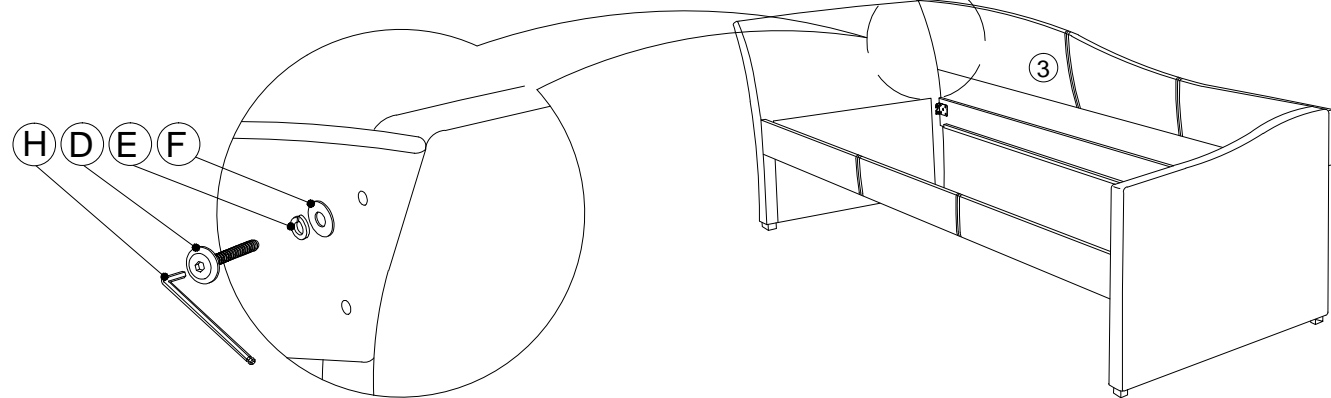

**STEP 4** Tighten all bolts from STEP 2 using the Allen Wrench (G) that has been provided. Now only tighten bolts for STEP 3 using Allen Wrench (H). Attach Slat (6) to Front Rail (4) and Back Rail (5) by unrolling and securing with 4 Wood Screws (A) 2 per each side. Tighten all screws using philips head screwdriver (not included)

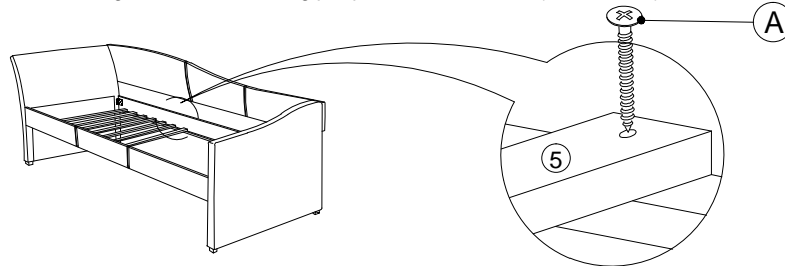

Your new day bed is now complete

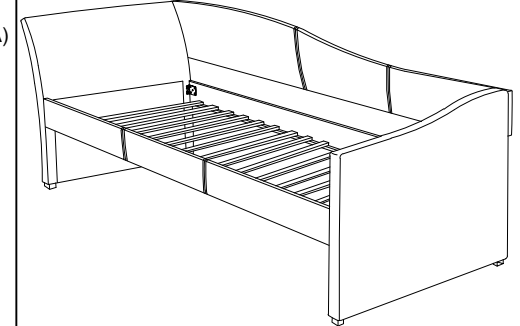

NOTE: AFTER A FEW DAYS OF ASSEMBLY, IT WILL HAVE ACCLIMATIZED TO THE ENVIRONMENT. PLEASE TIGHTEN ALL HARDWARE. CHECK TIGHTNESS OF ALL SCREWS EVERY 6-8 WEEKS.

# ASSEMBLY INSTRUCTION

MODEL : Vera Day Bed - TRUNDLE

NO	PART LIST	QTY
1	FRONT RAIL	1pc
2	BACK RAIL	1pc
3	SIDE RAIL	2pcs
4	SLAT 7pcs	2pcs
NO	HARDWARE LIST	QTY
A	CASTOR	6pcs
B	CHIPBOARD SCREW M4 x 16mm	24pcs
C	SCREW M4 x 32mm	8pcs
D	JCBB SCREW M8 x 20mm	8pcs
E	L - KEY M5 x 65mm	1pc

**STEP 1** Begin assembly by attaching each Castor (A) to the bottom of the Front Rail (1) and Back Rail (2) using 4 Wood Screw (B) per Castor.

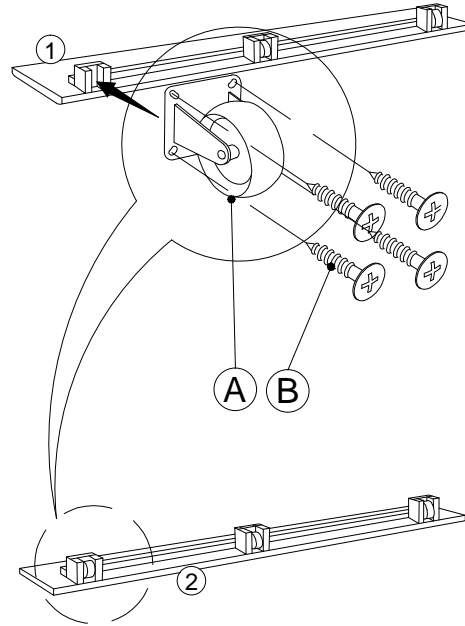

**STEP 2** Attach the Front Rail (1) and Back Rail (2) to the Side Rail (3) aligning holes and securing with 2 Allen Bolts (D) per each end. Tighten all bolts using the Allen Wrench (E) that has been provided.

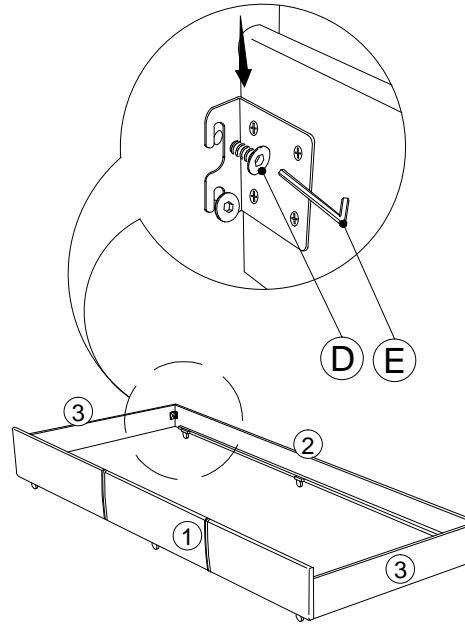

**STEP 3** Attach Slat (4) to Front Rail (1) and Back Rail (2) by unrolling and securing with 4 Wood Screws (C) 2 per each side. Tighten all screws using philips head screwdriver (not included)

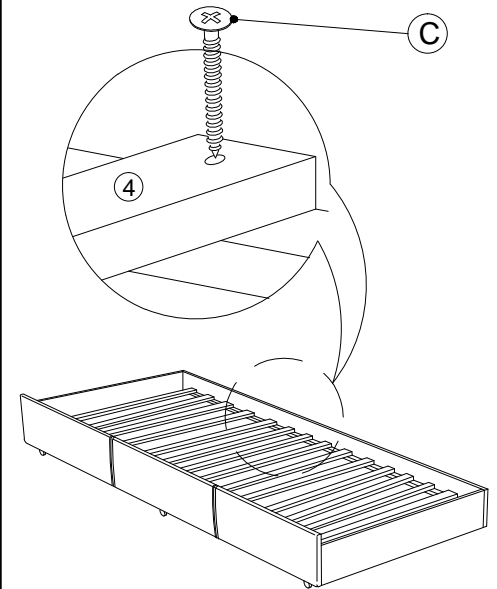

Your new day bed trundle unit is now complete

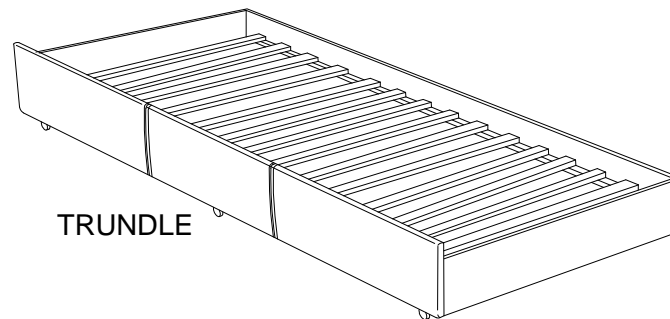

TRUNDLE

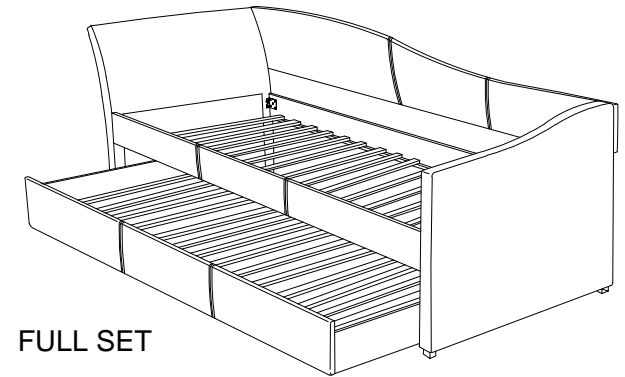

FULL SET

NOTE: AFTER A FEW DAYS OF ASSEMBLY, IT WILL HAVE ACCLIMATIZED TO THE ENVIRONMENT. PLEASE TIGHTEN ALL HARDWARE. CHECK TIGHTNESS OF ALL SCREWS EVERY 6-8 WEEKS.

01-JAN-16

PG : 1 / 1