

MODEL : BBT 8017 SF

ASSEMBLY INSTRUCTIONS

Read this instruction carefully. See hardware and furniture part list for guidance. Be sure all parts are complete, before you assemble. Place all wooden furniture parts on a clean and flat soft surface to prevent from being scratched.

Follow the figure to start assembling.

- CAUTIONS :**
1. Do not FULLY - TIGHTEN the nut or nut bolt until all nut or bolt is ready assembled.
 2. Do not OVER - TIGHTEN the nut or bolt to avoid causing damages to the thread.
 3. Keep all hardware parts out of reach of children.

NOTE : THE LIST AND QUANTITY SHOWN ARE FOR 1 UNIT ASSEMBLY.

PART LIST			HARDWARE LIST		
ITEM	DESCRIPTION	QTY	ITEM	DESCRIPTION	QTY
A	SOFA CHAIR	1 PC	1	JCBC Bolt M6 x 20mm	8pcs
B	FRONT LEG	2 PCS	2	M6 FLAT WASHER	8pcs
C	BACK LEG	2 PCS	3	M6 SPRING WASHER	8pcs
			4	M4 ALLEN KEY (BALL SHAPE)	1pc

STEP 1

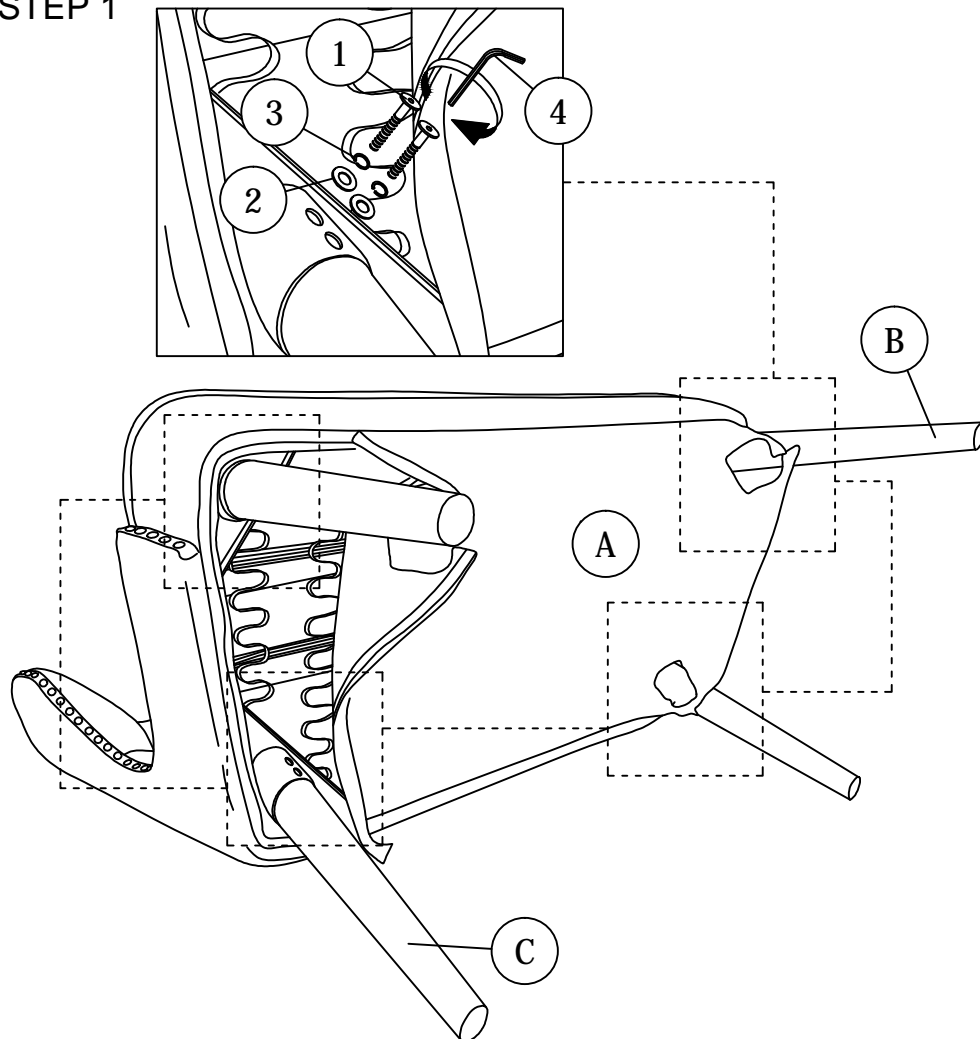

STEP 2

